

Hopkins File

<p>TO:</p> <p>MAIN OFFICE REGIONAL OFFICES</p> <p>SUPERSEDED BY EI 77-031 EFFECTIVE 5/1/1977</p>	 <p>ENGINEERING INSTRUCTION NEW YORK STATE DEPARTMENT OF TRANSPORTATION</p>
<p>Distribution:</p> <p><input checked="" type="checkbox"/> Main Office <input checked="" type="checkbox"/> Regions <input type="checkbox"/> Special</p>	<p>Code: <u>EI 72-110</u></p>
<p>APPROVED:</p> <p><i>R.M. Kamp</i> _____ Deputy Chief Engineer (Structures)</p>	<p>Date: <u>12/27/72</u></p> <p>Supersedes: BR 222</p> <p>Dated April 1965</p>
<p>SUBJECT:</p> <p>REVISED BRIDGE ROOM SHEET BR 222 Dated December 1972</p> <p>Subject Code: 7.35-1 - 222</p>	

A copy of BR 222 dated December 1972 is printed on the reverse side of this instruction.

The principal revisions are the deletion of the note, bend deductions and the 90 degree bend detail.

RNK/DJM/JFG/EK

REINFORCING BARS

LENGTH OF STIRRUPS AND TIES

All dimensions are out to out

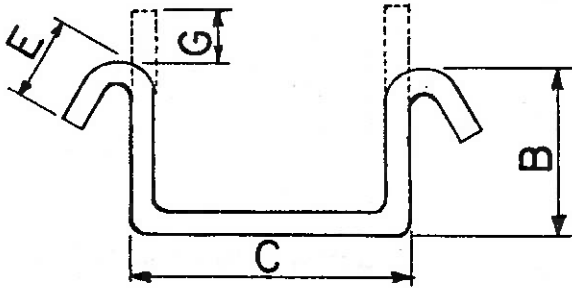

Bar Size	2	3	4	5	6
E	3 1/4"	4"	4 1/2"	5 3/4"	6 3/4"
G	3 1/2"	4"	4 1/2"	5 1/2"	6 1/2"

Length = $2B + C + 2G$

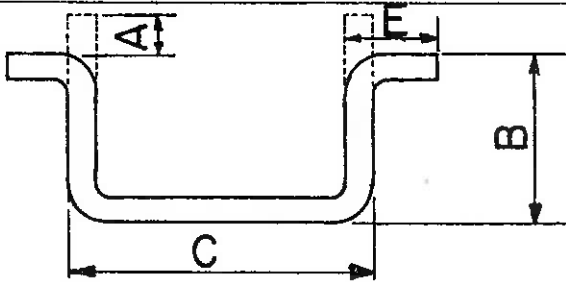

Bar Size	2	3	4	5	6
A	3"	3"	3 1/2"	4 1/2"	5 1/2"
E	3 1/4"	4"	4 1/2"	5 3/4"	6 3/4"

Length = $2A + 2B + C$

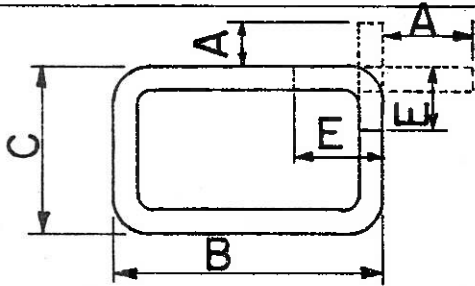

Bar Size	2	3	4	5	6
A	3"	3"	3 1/2"	4 1/2"	5 1/2"
E	3 1/4"	4"	4 1/2"	5 3/4"	6 3/4"

Length = $2A + 2B + 2C$

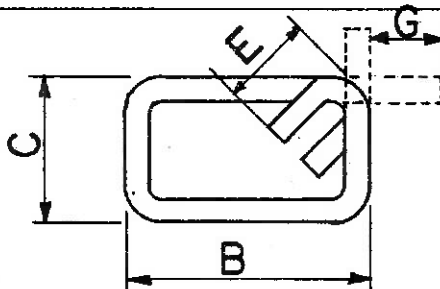

Bar Size	2	3	4	5	6
E	3 1/4"	4"	4 1/2"	5 3/4"	6 3/4"
G	3 1/2"	4"	4 1/2"	5 1/2"	6 1/2"

Length = $2B + 2C + 2G$

Dimensions A & G must be shown on bar bending details.

It is not necessary to show dimension E.

Refer also to BR 221.

DEC. 72

BR 222